

New Multifunctional JP-Electric Retract controller V1 and V2

Instruction Manual



For JP Hobby Alloy Electric Retracts Landing Gear ER-005 / ER-010 / ER-120 / ER-150 / ER-200

A- Multi-function landing gear controller features:

1. Automatic identification current
2. Set the voltage of the door servo
3. Set the CW and CCW direction and stroke of the door servo
4. Set the door retraction sequence

Long press the mode button to enter the setting mode:

1. When the A or B light is flashing, press the + / - button to set the servo CW and CCW direction function.
2. When A+B flashes alternately or C+D flashes alternately, press + / - button to set the stroke of the servo.
3. When the C lamp is flashing, it is V1 mode.
4. When the D lamp flashes, it is V2 mode.

JP HOBBY is distributed in Europe by WEB EFFECT / TURBINES RC

New Multifunctional JP-Electric Retract controller V1 and V2

Cinématique du séquenceur en mode V1

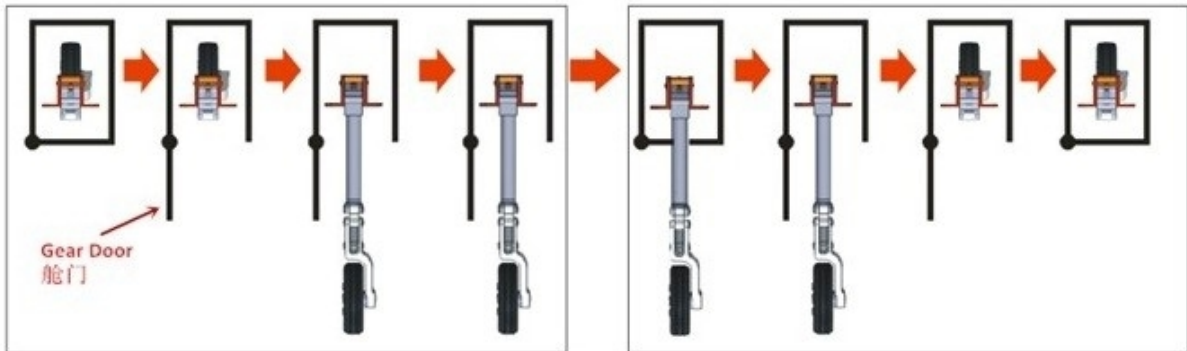

Cinématique du séquenceur en mode V2

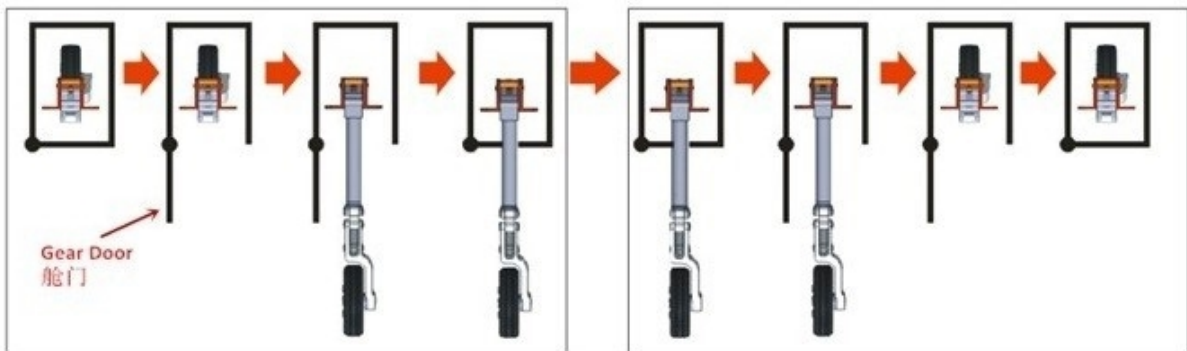

New Multifunctional JP-Electric Retract controller V1 and V2

B- Electric retract control operating principle:

In the normal service condition,

- Turn on the retract switch then the control system will activate the retraction system to open after checking the door fully open by Auto. The doors will close after the retract are open.
- Turn off the retract switch then the control system will activate the retraction system to close after checking the doors fully open by Auto. The doors will close again after the retract are close.

Start the Retract channel	Gear door OPEN	Retract DOWN	Gear door CLOSE	Shutted down Retract channel	Gear door OPEN	Retract UP	Gear door CLOSE
---------------------------	-------------------	-----------------	--------------------	------------------------------	-------------------	---------------	--------------------

C- Retracts installation, operation and maintenance

Installation:

Installation is simple. The Retracts have a stander clamping and its installation is similar to any standard retract. An advantage of the electric retract is that installations of complex valves and air circuits are unnecessary. The Retracts are supplied with long enough cable which is directly connected to the control unit. If the cable is no long enough, it can be extended with the correct polarity. Is advisable prolong just the necessary length to avoid voltage drops.

Operation:

Retracts must be operated always through JP Retract Control units. Never operate the retracts with direct battery or with other brands control units. The best quality of electric retracts. You will notice the advantage of not having to compress air before each flight, and you will forget the leaks.

New Multifunctional JP-Electric Retract controller V1 and V2

Retracts Trouble shooting:

Problems	Solutions	
The Retract doesn't move	Check whether the retract controller signal lines connected correctly	The retract controller signal lines connected to the retract channel again
	Check whether the remote control signal is normal	Check the switch channels. Good debugging remote control signal
	Check whether the remote control retract channel release percentage is set to $\pm 100\%$	sure the release percentage is set to $\pm 100\%$
	Check whether the 6V power supply is to run out of electricity	6V battery charged
The gear door doesn't open	Check whether doors servo signal lines connected correctly	Please follow the labeled correctly connected in the controller
	Check whether door servo damage	Change the door servo
	Check whether three units retract are connected to the retract controller	Please connect three units retract to the control system
The gear door run is in wrong direction	Please check the doors servo signal lines connected to the right channel	Change the doors servo signal lines from wrong channel to other one
Three units retract not work in the same direction	Check the retract cable is correct	Reverse running horse cables properly connected to the controll